



COLUMBIA UNIVERSITY -
MANHATTANVILLE

RETAIL SPACE

F O R L E A S E

COLUMBIA BUSINESS SCHOOL

HARLEM, MORRINGSIDE HEIGHTS, HAMILTON HEIGHTS, MANHATTANVILLE

Over the past few years, the trade area surrounding the site has attracted significant commercial, educational, residential and retail investments that have significantly added to the neighborhood's vibrancy and quality of life.



© Frank Oudeman/Columbia University



TRADE AREA



MANHATTANVILLE

The Manhattanville campus is situated between City College just to the north, Columbia's Morningside campus just to the south and the Manhattanville Factory District to the east.

The campus plan includes up to 6.8 million square feet of space for teaching, research, university housing and support services. It features new facilities for civic, cultural, recreational and commercial activity. Its improved pedestrian-friendly streets and new publicly accessible open spaces will connect Harlem to the new Hudson River waterfront park.

The Campus currently includes: the 450,000 SF Jerome L. Greene Science Center, the 60,000 SF Lenfest Center for the Arts, the 56,000 SF, 430+ seat Forum, the 210,000 SF Studebaker Hall, and the 100,000 SF Prentiss Hall.

Scheduled for opening in 2022 is the Columbia Business School which consists of two buildings — Henry R. Kravis Hall and David Geffen Hall — for a total of 480,000 additional square feet.



CAMPUS



COLUMBIA BUSINESS SCHOOL
HENRY R. KRAVIS HALL

Comprising 2 buildings — Henry R. Kravis Hall and the David Geffen Hall — the Manhattanville campus will be the new home of the Columbia Business School.



BUILDING

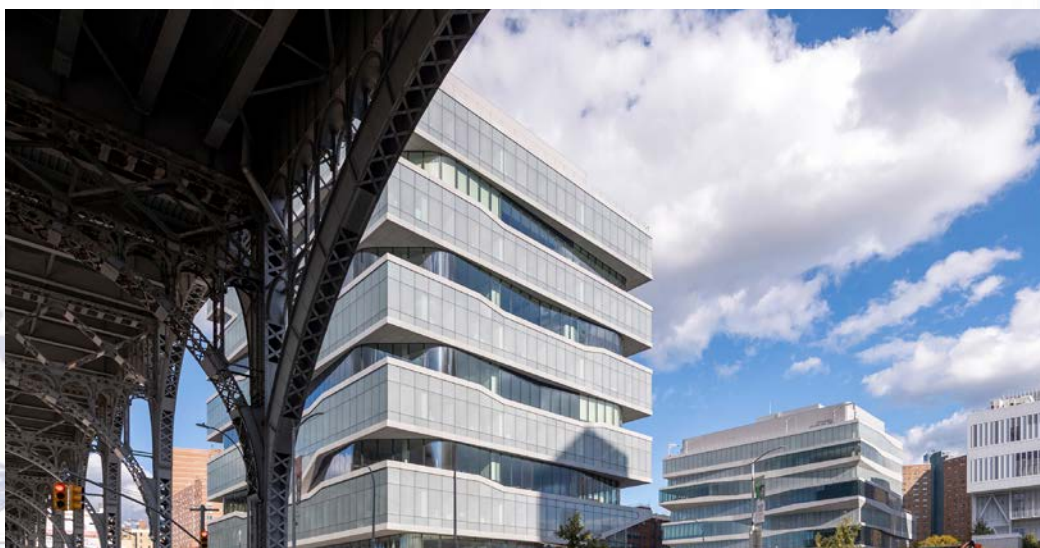
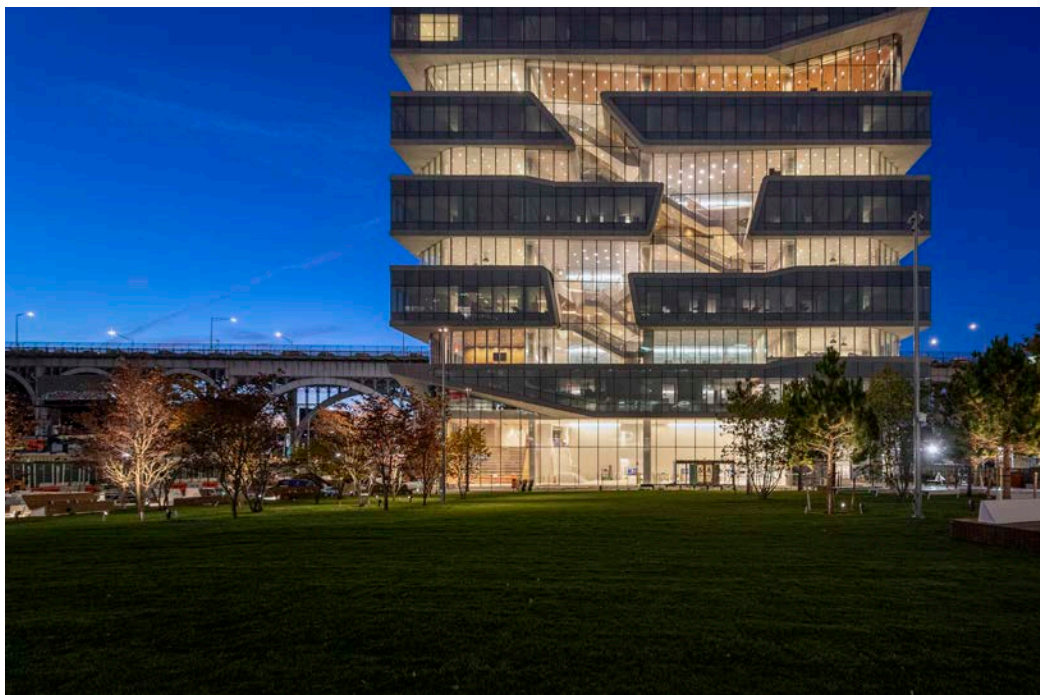

AVAILABILITY

4 retail spaces are available to lease in Kravis Hall.

ADDRESS

Henry R. Kravis Hall — Columbia Business School
2285 - 2293 12th Avenue
650 West 131st Street
New York, NY 10027

PREMISES

- SPACE A1: 1,397 SF
- SPACE A2: 848 SF
- SPACE A3: 1,297 SF
- SPACE B: 1,928 SF

Ground Floor

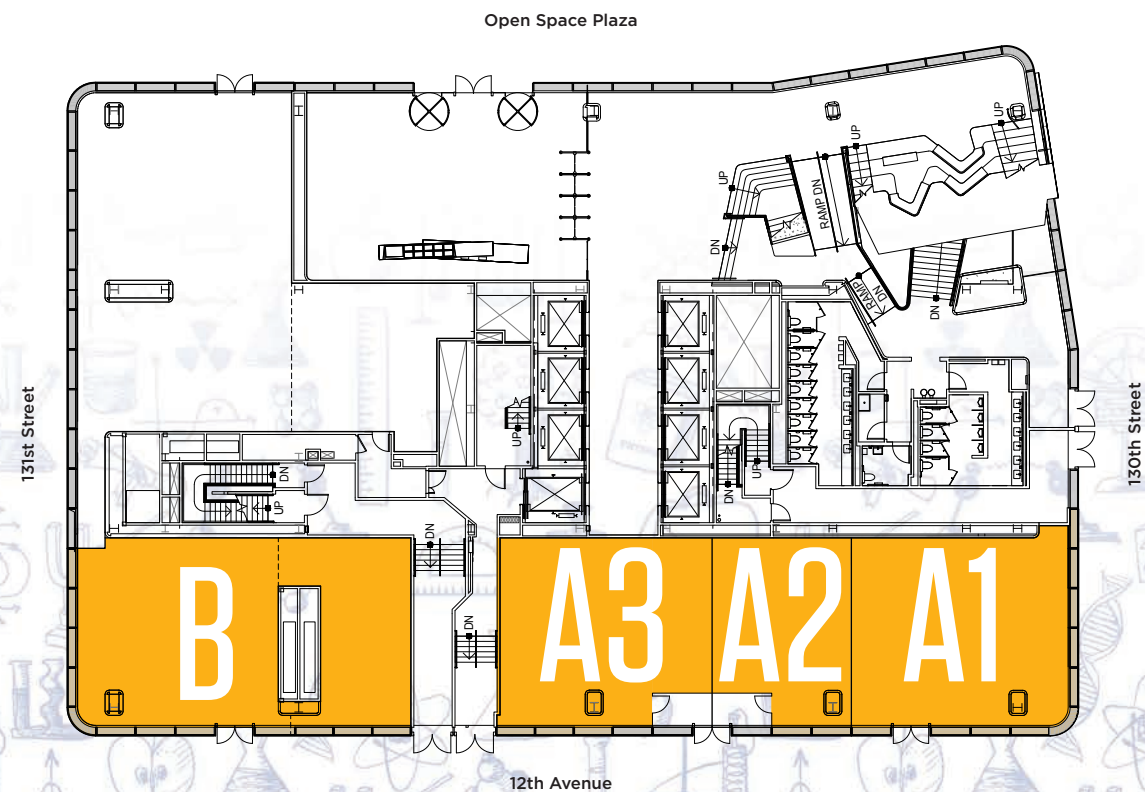

RETAIL

SPACE A

ILLUSTRATIVE RENDERING



SPACE B

ILLUSTRATIVE RENDERING



SPACES A & B





COLUMBIA UNIVERSITY
IN THE CITY OF NEW YORK

COLUMBIA UNIVERSITY – MANHATTANVILLE R E T A I L

For more information, please contact the exclusive agents:

KENNETH HOCHHAUSER

212.792.2605

khochhauser@winick.com

YOEL GORJIAN

212.792.2646

ygorjian@winick.com

winick



COLUMBIA UNIVERSITY
IN THE CITY OF NEW YORK

Winick Realty Group LLC - Licensed Real Estate Brokers
655 Third Avenue, 17th Floor • New York, NY 10017 • T. (212) 792.2600 • www.winick.com

ALTHOUGH ALL INFORMATION REGARDING PROPERTY FOR SALE, RENTAL OR FINANCING IS FROM SOURCES DEEMED RELIABLE SUCH INFORMATION HAS NOT BEEN VERIFIED, AND NO EXPRESS REPRESENTATION IS MADE NOR IS ANY TO BE IMPLIED AS TO THE ACCURACY THEREOF, AND IT IS SUBMITTED SUBJECT TO ERRORS, OMISSIONS, CHANGE OF PRICE, RENTAL OR OTHER CONDITIONS, PRIOR SALE, LEASE OR FINANCING, OR WITHDRAWAL WITHOUT NOTICE.